

VENUE SPECS

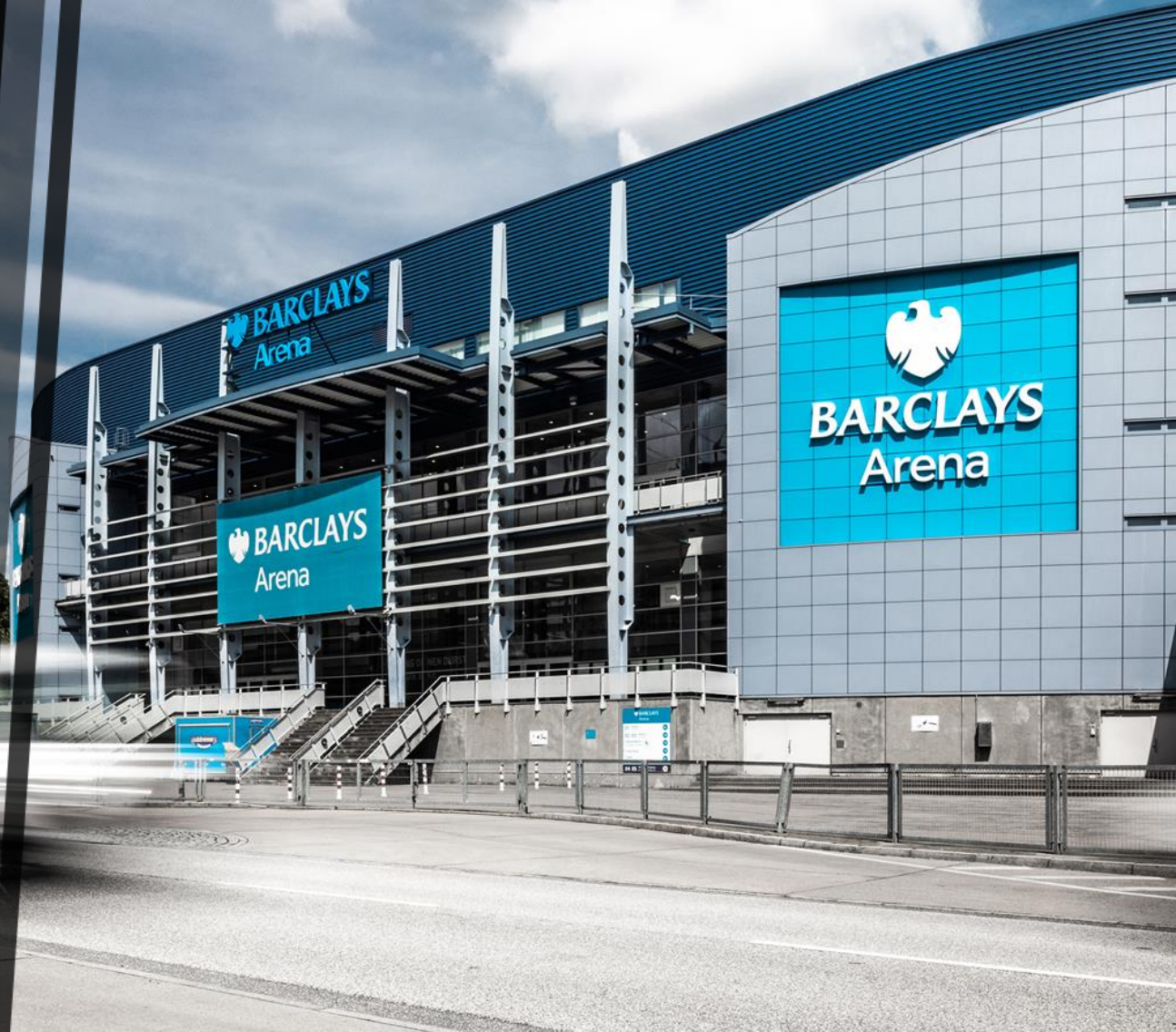

CONTENTS

VENUE SPECS BARCLAYS ARENA HAMBURG

/ Approach.....	3
/ Check-In.....	4
/ Parking.....	5
/ Loading.....	6
/ Backstage.....	7
/ Variants.....	9
/ Equipment.....	10
/ Interior.....	11
/ Strom.....	12
/ Rigging.....	13
/ Sections.....	14
/ Merchandise.....	15
/ Good to know.....	16

APPROACH

HELLGRUNDWEG 44 | 22525 HAMBURG | GATE 1
(LATITUDE : 53,5899° | LONGITUDE: 9,8976°)

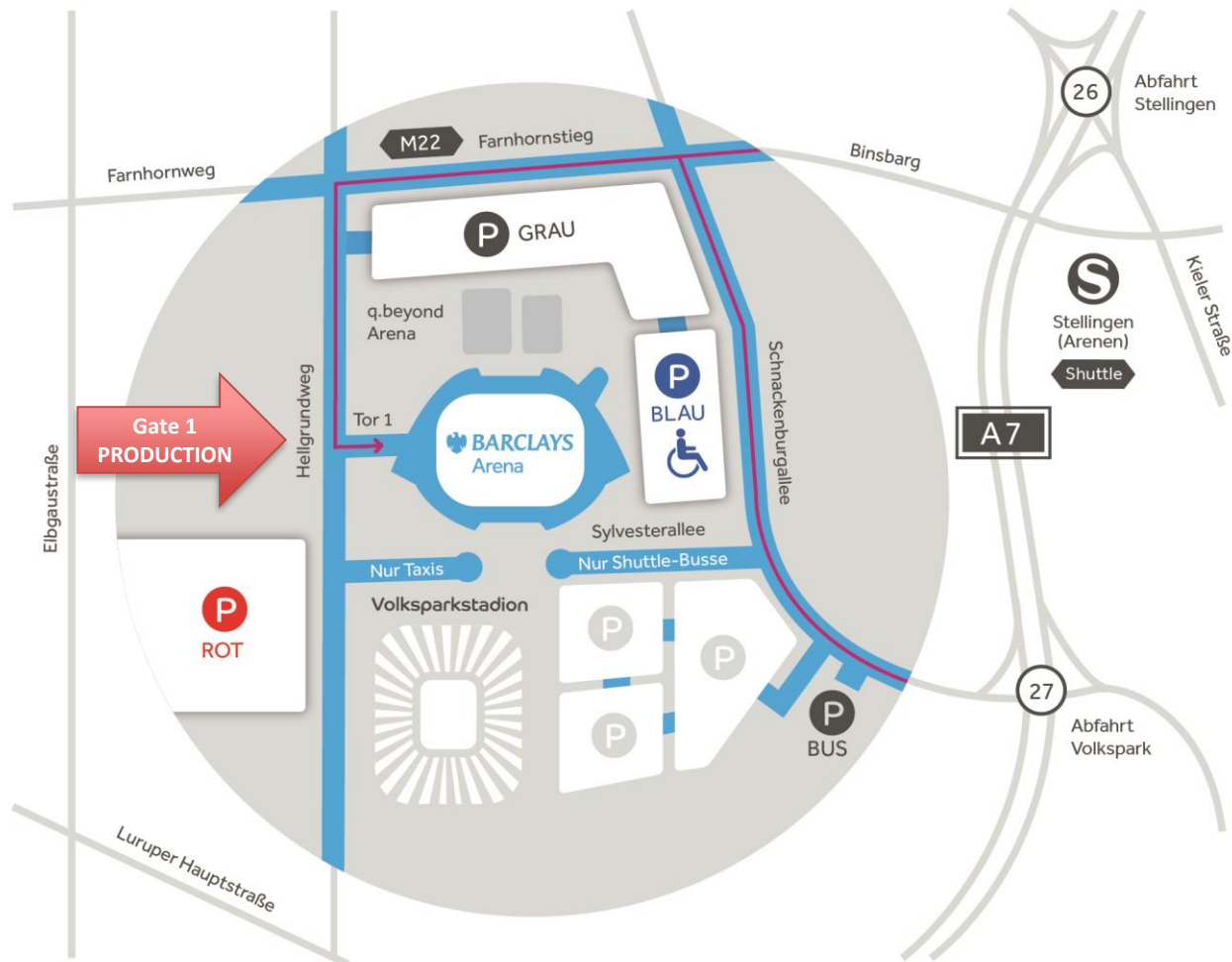

CHECK-IN

CHECK-IN FOR ALL

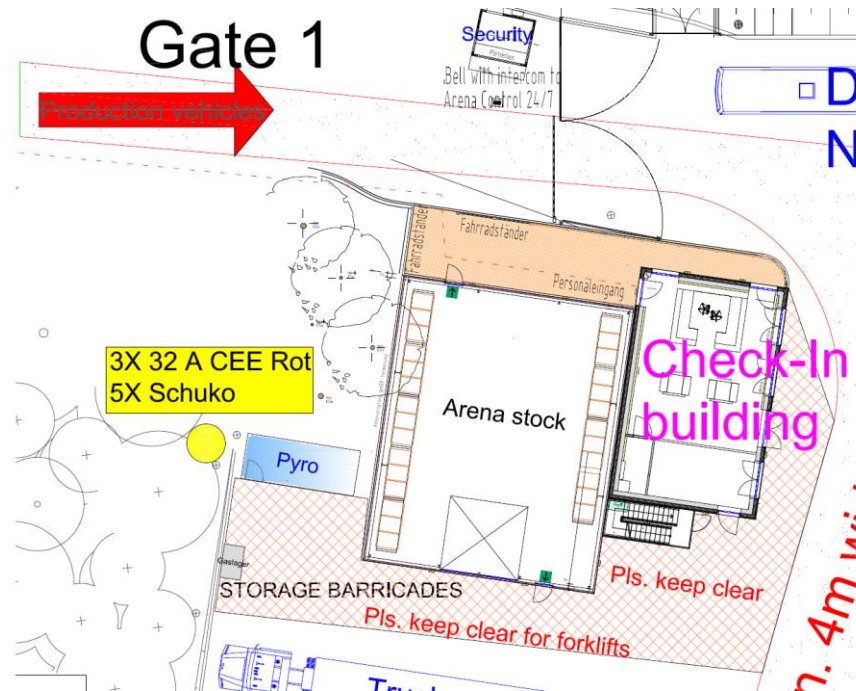

- / Entrance to backstage area / production area / loading docks only through Check-In building or Gate 1 (busses, trucks incl. staff).
- / Check-In counter for local promoter/tour
- / Check-In counter for arena staff
- / Barclays Arena: staff & service providers
- / Promoter: staff, service providers & tour staff
- / Check-In counter must be staffed from load in on

LOADING

FROM THE PRODUCTION AREA INTO THE ARENA

- / 2 loading gates Stage Right
4,10 m x 4,41 m (H x W)
- / 1 loading gate Stage Left
4,10 m x 4,01m (H x W)
- / Simultaneous loading and unloading of 3 trucks
- / Lighted
- / Inner bowl fully accessible by trucks

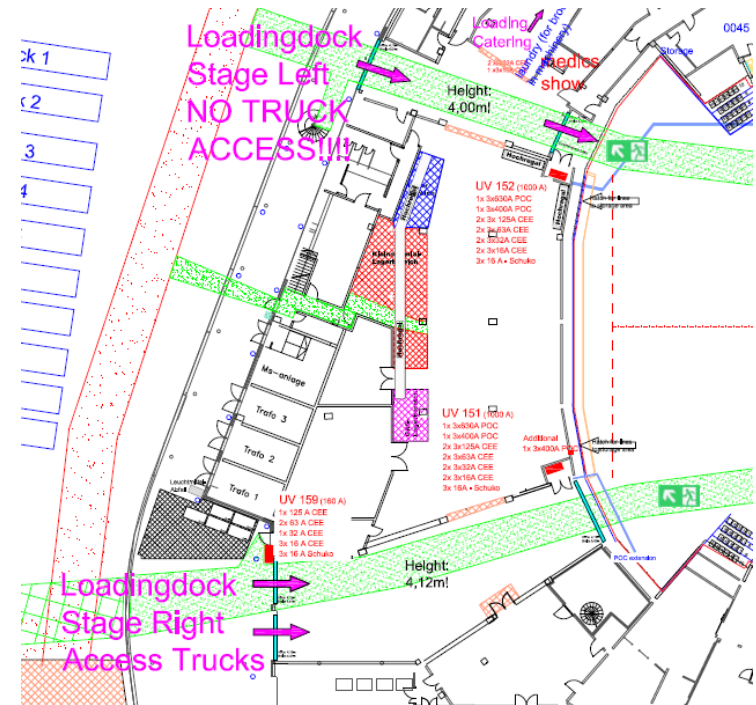

BACKSTAGE

GENERAL



- / 17 rooms
- / 3 direct entrances to the infield/stage
- / Sauna
- / Borehole in each rooms for external cables
- / Fully accessible from Loading Dock to Infield
- / Water and wast water connection in Loading Dock area Stage Left

BACKSTAGE

ROOMS

- / 10 Production rooms: air-conditioned | wash basin | power connection | sound optimized | dimmable lighting
- / 4 locker rooms: air-conditioned | group shower and toilettes | power connection
- / 4 dressing rooms: air-conditioned | separat shower and toilette | power connection | dimmable lighting
- / Catering kitchen: cooker: 4 hot plates | grill | oven | sink | fridges
- / Dining Room: about 50 seats
- / Press conference room: air-conditioned | power connection| PAR 56 spotlight (not mobile)

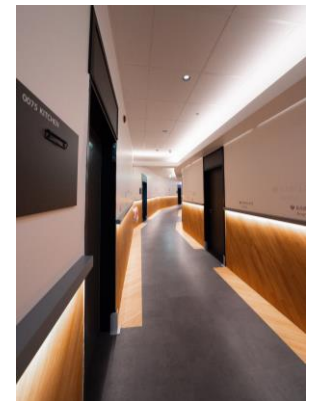

VARIANTS

AT A GLANCE

	without upper tier	with upper tier
	standing/ seating	standing/ seating
End Stage	8.300/ 13.300	13.500/ 13.300
End Stage 2/3	7.400/ 6.100	11.000/ 9.800
Half House	6.000/ 5.600	9.700/ 9.400
Extend. Theater	4.200/ 3.500	

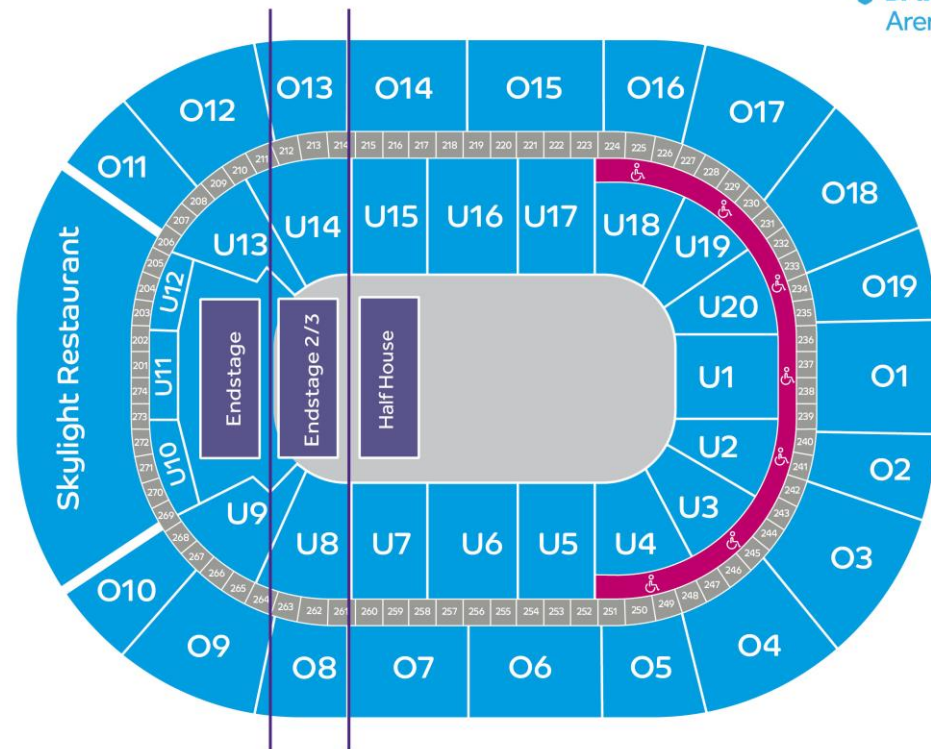

EQUIPMENT

EXCERPT

- / Variable stands
- / Variable backdrop and curtains to separate areas
- / Flexible Uppertier coverage
- / LED Sport lighting
- / Suite curtain
- / In house sound system
- / Fascia Board (360°-LED-board)
- / In house TV System
- / Free Wifi for up to 20.000 guests

Current stock upon request

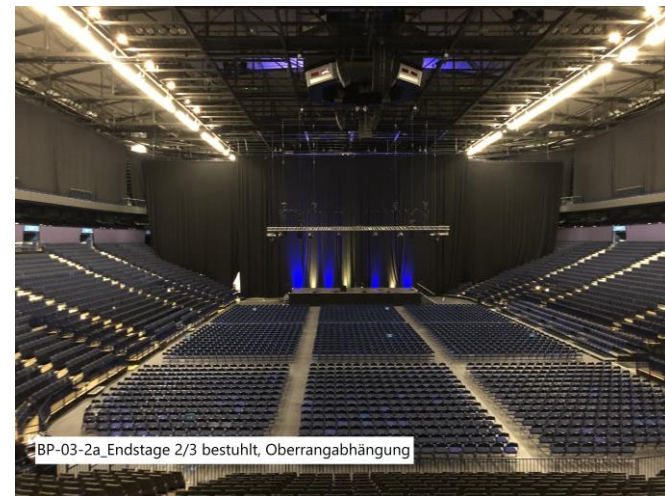
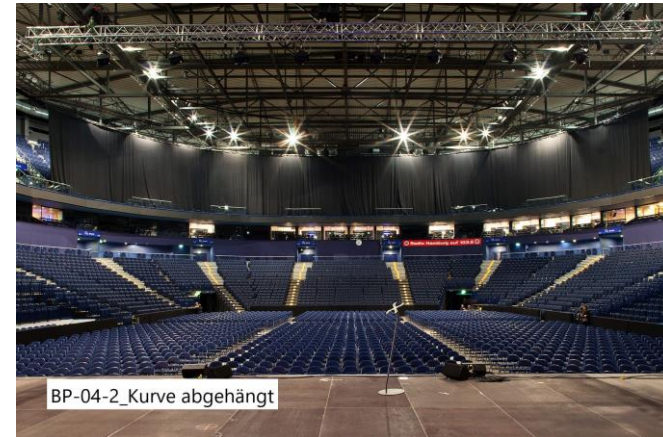

INTERIOR

EXCERPT

- / 200 stage decks (Bütec | 2 x 1 m)
- / about 2.500 chairs (infield chairs)
- / Pipe & Drape System
- / 3 fork lifts (Gas: 2,0 t | 3 x 3,5 t) available
- / Conference Sound System for mobile usage
- / Handball play field Speed Lock DIN 18032 Teil 2
- / Chairs, Tables, sofas, and fridges (823 Litre) for the backstage area
- / Crowd barriers, barriers (protections mats), Mannesmann barriers
- / Walk-through metal detectors at every entrance
- / Yellow Jackets
- / Tensators

Actual stock upon request

RIGGING

FURTHER INFORMATION UPON REQUEST

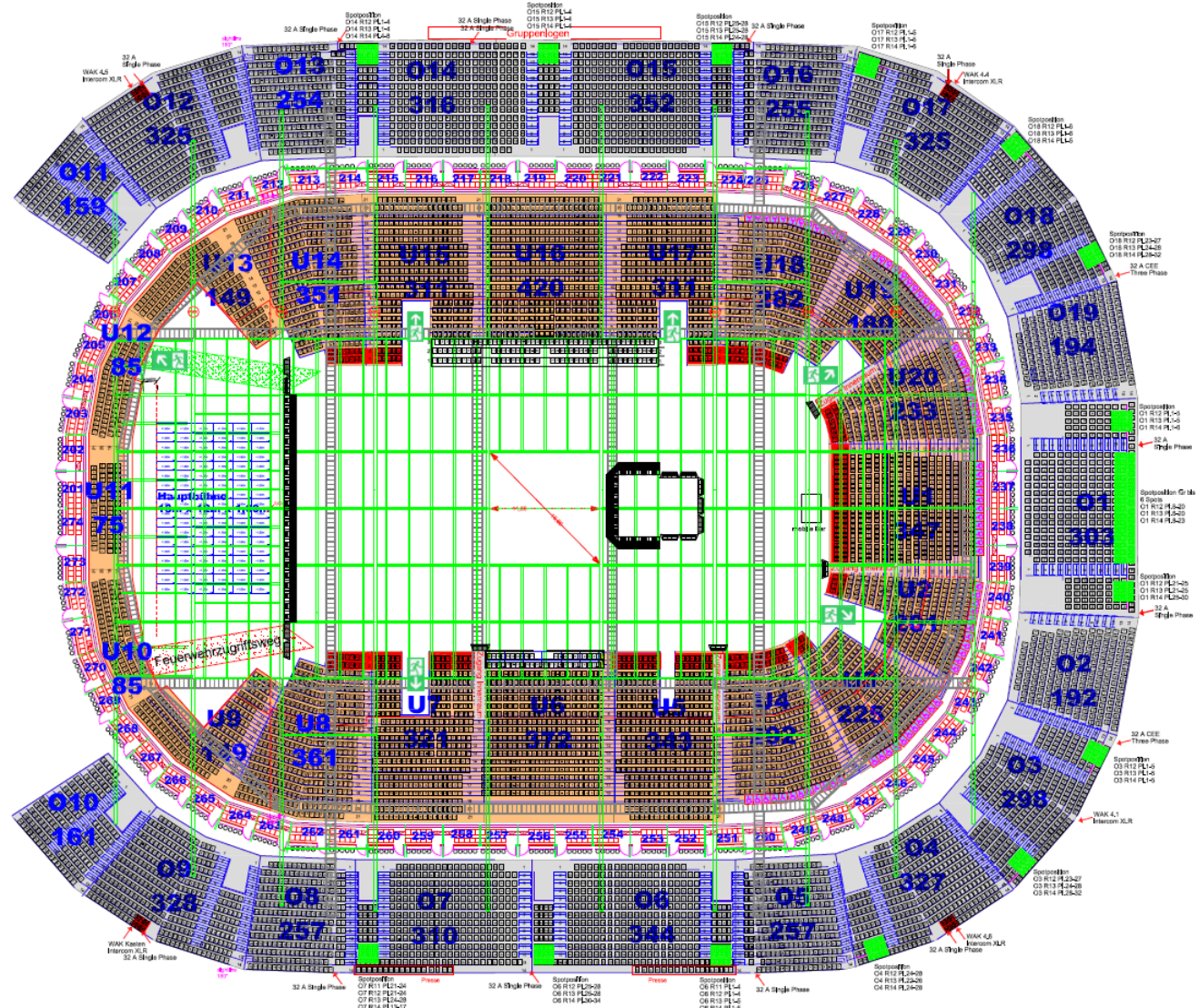

SECTIONS

LENGTHWISE & CROSSWISE

lengthwise

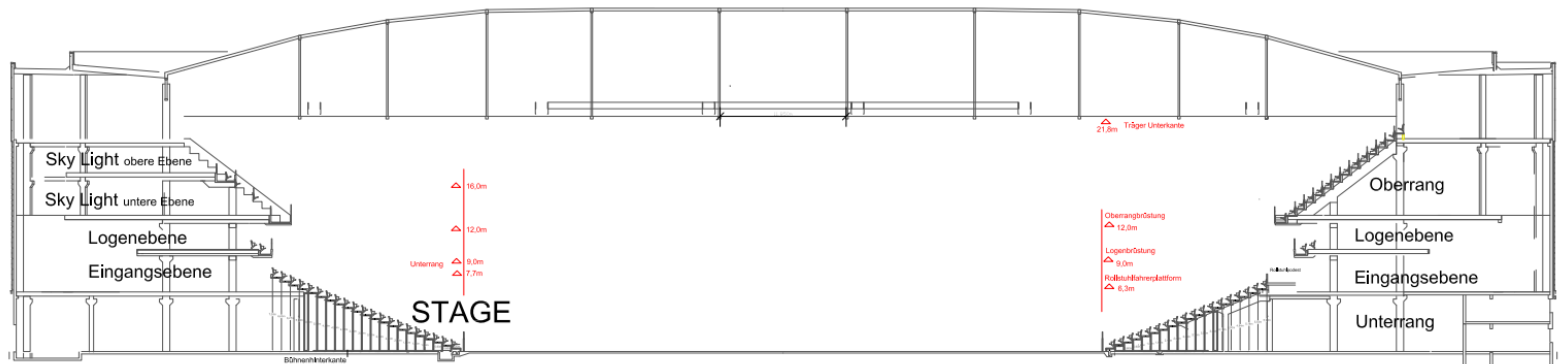

crosswise

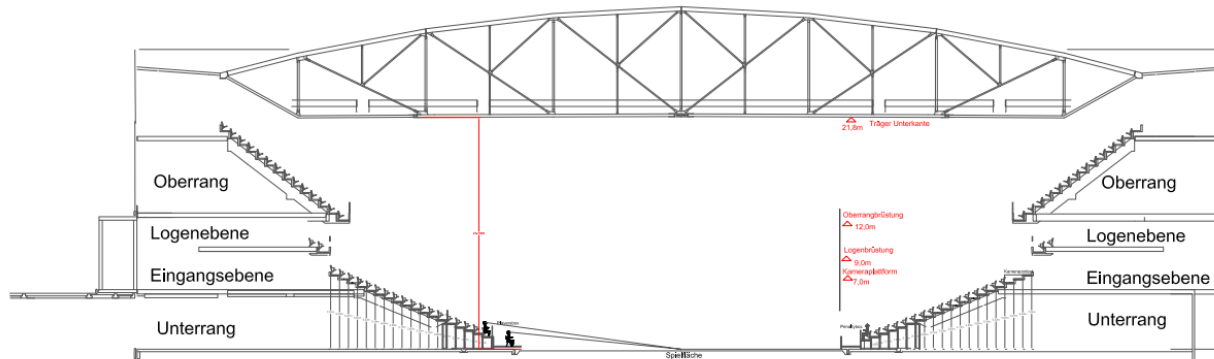

MERCHANDISE

CONCESSIONARY BARCLAYS ARENA

/ WM SportKultur GmbH

Contact: Stefan Arndt

Phone: +4930 / 585 831 320

Mail: s.arndt@sportkultur.de

Address: Wolfener Str. 32-36 | Aufgang C
12681 Berlin

/ Merchandise areas: At each entrance

E1, E2 & E3 possible

/ Goods deliveries to:

Barclays Arena | Hellgrundweg 44 | 22525 Hamburg
z. H. Stefan Arndt



GOOD TO KNOW

HAMBURG

/ Distance to...

... the airport:

about 12 - 16 km

about 20-30 minutes (depends on traffic)

w: www.hamburg-airport.de

...Central Station:

about 10 km

about 20 - 30 minutes (depends on traffic)

w: www.bahnhof.de/bahnhof-de/bahnhof/Hamburg_Hbf-1030112

GOOD TO KNOW

HOSPITALS & HOTELS

/ Nearest Trauma Center:

UKE
Universitätsklinikum Hamburg-Eppendorf
Martinistraße 52
20246 Hamburg
Central emergency number:
+49 40 7410 – 0

/ Nearest Hospital:

AK Altona
Asklepios Klinik Altona
Paul-Ehrlich-Straße 1
22763 Hamburg
phone: +49 40 18 18 81 – 0
Central emergency number:
+49 40 18 18 81 - 15 01

/ Hotel

SYLC. Apartmenthotel

Kronsaalsweg 88
22525 Hamburg-Stellingen
+49 40 5375130
info@sylc.de
www.sylc.de

/ Hotel

Lindner Park-Hotel Hagenbeck

Hagenbeckstraße 150
22527 Hamburg
+49 40 800 808 100
www.lindner.de/hamburg-park-hotel-
hagenbeck/ankommen.html

AEG Arena Hamburg GmbH
Hellgrundweg 44
22525 Hamburg
Tel. +49 40 88163 0
Mail: info@barclays-arena.de
www.barclays-arena.de

